

ISO Flange Assembly Instructions

Optional fastener flanges are joined around the periphery with clamps. Double claw clamps are used when a pair of OF flanges are joined (see diagram A), or single claw clamps are used to join an OF flange to a tapped nonrotatable on a pump or gate valve (see diagram B). This fastening method allows the OF flange to be rotated for ease of component alignment.

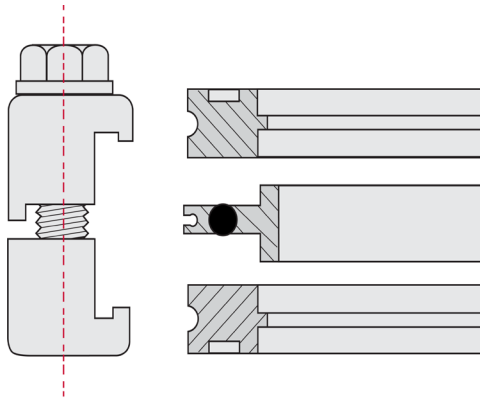

A. Optional Fastener / Optional Fastener
with Double Claw Clamp

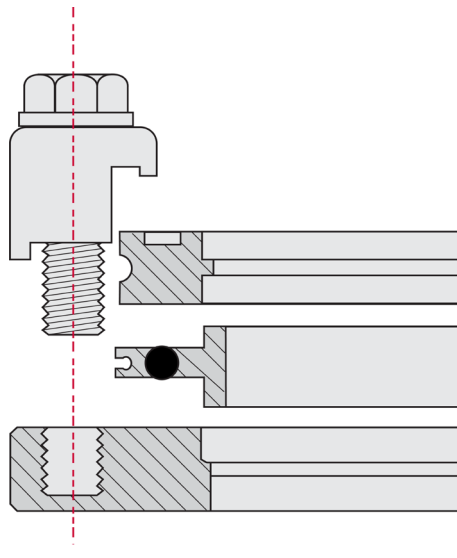

B. Optional Fastener / Tapped
Unrotatable with Single Claw Clamp

